





PRB MOUSSE PU10 EPS ADHESIVE

ADHESIVE FOAM FOR EPS INSULATING PANELS



PRB MOUSSE ADHÉSIVE PU 10 PSE
PREPARATION FILLING AND BOX HOLES

The of PRB MOUSSE ADHÉSIVE PU10 PSE

-  Ready-to-use, easy and quick application
-  Permanent and fast fixing
-  Compensation of levelness faults
-  Very good adhesion to most building materials
-  Resists to ageing, heat and water



PACKAGING

– PU010 foam is available in boxes of 12 750 ml spray cans.

STORAGE: 12 months.

CONSUMPTION

– 1 PU10 EPS Adhesive foam spray can can cover 5 m², which is as much as a 25 kg bag of mortar

AREA OF USE

USE

- MOUSSEPU10 adhesive foam has been specially designed for bonding insulating panels (EPS, XPS, etc.) to building substrates.
- It also allows the filling of any voids between panels.

ASSOCIATED INSULATION MATERIALS

- EPS insulation panels.

APPLICATION CONDITIONS

- PU010 foam must be used at an ambient temperature of between 0 and 35°C.
- The spray can must be at a temperature between 10 and 30°C.
- The supports must be solid, dust-free and degreased, without blooming or laitance.
- The substrate temperature must not exceed 50°C.
- If necessary, moisten the adhesion surfaces before applying the adhesive foam.

TECHNICAL CHARACTERISTICS

PRODUCTS

- Fire behaviour class DIN 4102-1: B1 (flame retardant), PNDS04-664
- EN 12667 thermal conductivity: 0,40 W/(mk)
- ISO 844 compressive strength: 30 kPa (10% deformation)
- EN 1607 Tensile strength: 100 kPa

- Elongation at break DIN 53455: 15 %
- Shear strength EN 12090: 80 kPa
- Temperature resistance: from -40 to 90°C.

N.B.: Our Technical Department is at your disposal for any further information.

Note: this document contains information given in good faith and based on the current state of our knowledge. It is only indicative and therefore does not imply any commitment on our part, in particular in the event of infringement of the rights of third parties as a result of the use of our products.

This information should not be used as a substitute for the preliminary tests required to guarantee that the product is suitable for each intended use. Users are invited to check that they are in possession of the latest version of this document. Technical data date: 09/2014 The manufacturer reserves the right to make changes.

APPLICATION

PREPARATION

- Optimum use temperature: 20°C.
- Shake the spray can vigorously at least 20 times before use.
- Screw the spray can tightly onto the gun with the valve pointing downwards.
- Dose the extrusion by lightly pulling the gun trigger and adjust the quantity with the adjusting screw.
- First apply a peripheral bead of PU010 adhesive foam to the back of the insulating panel.
- Spray a large "M" in the middle of the insulating panel.
- For better results, always hold the gun vertically while applying the adhesive. The spray can should always have the valve at the bottom.

- Wait for the slight post-expansion to complete.
- Then mount the insulating panel with a light pressure.
- Use time: 10 minutes.
- Open joints between insulating panels can be filled with PU10 foam (or M110 foam).
- Cut off residue and excess foam after curing using a suitable tool.
- In case of interruption, always leave the spray can on the gun and fully close the adjusting screw.

- Drying time for a 30 mm bead, at 23°C and 50% RH:
 - No longer tacky: after 10 min.
 - To be sliced: after 30-40 min.
 - Through: after 3 hours (Wait about 3 hours before Future panel treatment).
 - Final strength: after 24 hours.

PRECAUTIONS FOR USE

- Application outdoors or in well-ventilated rooms.
- Do not smoke.
- Wear protective clothing, gloves and protect eyes and face.
- Protect from UVs and temperatures above 50°C.
- Cover the floor with paper or plastic film.
- Store spray cans upright.

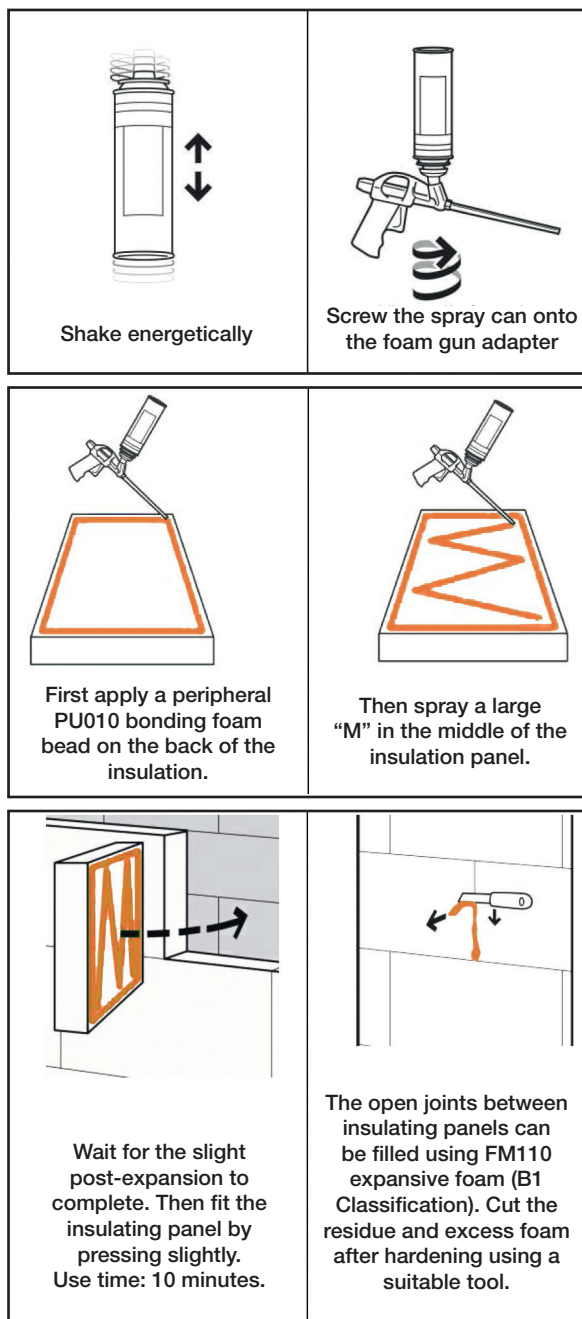

ADHESIVE FOAM CLEANER

PU10 EPS

AREA OF USE

- AA290 has a screw adapter head for guns and a spray nozzle.
- AA290 is particularly suitable for removing uncured expansive foam, it can also be used to clean fresh paint, wax, grease, oil and adhesive residue.

ADVANTAGES

- Double use as a spray or spray gun.
- Stain remover / degreaser.

DESCRIPTION

- Special acetone based multi-purpose cleaner, which is used to clean foam guns and their adapters.

PRESENTATION

- 500 ml spray can, with gun adapter screw and removable spray nozzle.

PACKAGING

- Colour: Clear
- Items/Box: 12 500 ml spray cans

USE

USE AS A GUN CLEANER

- 1) Unscrew the expansive foam spray can from the gun.
- 2) Screw the Cleaner with its adapter onto the gun.
- 3) Use the spray through the gun to remove all the foam.
- 4) Let the gun stand for a maximum of 15 minutes to allow the Cleaner to work.
- 5) Repeat the operation (item 3).
- 6) Unscrew the Cleaner from the gun.
- 7) Wipe off any excess cleaner from the adapter using a cloth. Then spray the adapter thread with the spray.

HEALTH AND SAFETY PRECAUTIONS

- Pressurised vessel.
- Protect from sunlight, do not expose to temperatures above 50°C.
- Do not open forcibly, do not pierce, do not burn, even after use.
- Do not spray on a flame or incandescent material.
- Keep out of reach of children.
- Keep away from all sources of ignition.
- Do not smoke.
- Avoid the accumulation of electrostatic charges.
- Do not breathe the vapours.
- Do not empty waste into drains.
- Carry out compatibility tests before use.
- Store in a cool, dry and well ventilated place.